



Orthogen[®] for CADWorx[®]

2D Plans, Sections, and Elevation Drawings

Capabilities:

- Integrated with BricsCAD[®] and AutoCAD[®]
- Operates on native viewports and xRefs
- Delivered with 40 pre-defined view styles
- Easy repositioning and rotating of labels
- Support for Dimension Elements
- Automatic column grid references
- Fast, high resolution, white space search algorithms

OrthoGen for CADWorx Plant Professional enables 2D plans, sections, and elevations drawings to be created automatically from CADWorx Plant Professional 3D models. Even in today's 3D world, annotated and dimensioned orthographic drawings are still a required deliverable. OrthoGen reduces this process from hours to only minutes.

Integrated with BricsCAD[®] and AutoCAD[®]

The OrthoGen integrated drawing interface quickly reads properties directly from CADWorx model files. Because OrthoGen can operate within the BricsCAD and AutoCAD environments, users can auto-annotate and conduct other 2D embellishments through viewports. OrthoGen also integrates well with existing userdeveloped CADWorx commands, details, standards, and block libraries.

Multiple Viewports and xRefs

OrthoGen enables the use of multiple viewports and utilizes data from xRefs up to three levels deep. Because of this flexibility, users can create drawings representing multiple scales and views. Orthogen is also tightly integrates into the AutoCAD environment and supports the AutoCAD User Coordinate Systems (UCS).

Flexible Settings and Standards Creation

The user interface enables users to select from thousands of option combinations. These combinations can be saved as drawings styles for future individual or group use. In addition, the production mode interface provides easy enforcement of project standards. To ensure user productivity, OrthoGen comes with 40 predefined and editable drawing styles, so users can be up and running in no time.

Easy Label Repositioning and Modification

When using OrthoGen in the CADWorx environment, you can take advantage of basic BricsCAD and AutoCAD commands to move and rotate labels. These edits are preserved when running updates on the drawing, eliminating unnecessary rework. Users can also add additional dimensions, hatching, notes, details and more.

Automatic Column Grid References

Creating a single grid model helps to coordinate and automate the placement of grid labels for all drawings on a project. Grid models provide a firm dimensional base that helps eliminate guesswork and the introduction of errors.

Annotations Where You Want Them

The fast, high-resolution, white-space search algorithms enable you to generate orthographic representations that will automatically avoid areas that you do not wish for dimensions or annotations to appear. Commands also help define dimension “edges” on the drawings.

Technical Specifications

- AutoCAD®-compatible
- BricsCAD®-compatible (Recommended)

Application Areas

Process and Plant Design, Piping, Equipment, Steelwork, Petrochemical, Chemical, Power, Offshore, Food, Beverage, Brewing, Pharmaceutical, Water Treatment, Building Services, Shipbuilding, and Architectural.

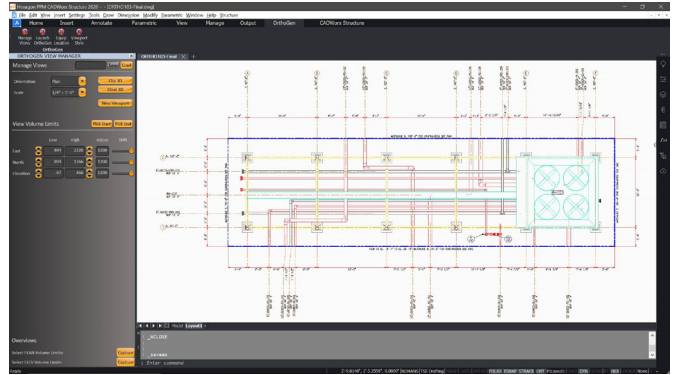

About Hexagon

Hexagon is a global leader in digital reality solutions, combining sensor, software and autonomous technologies. We are putting data to work to boost efficiency, productivity, quality and safety across industrial, manufacturing, infrastructure, public sector, and mobility applications.

Hexagon's Asset Lifecycle Intelligence division helps clients design, construct, and operate more profitable, safe, and sustainable industrial facilities. We empower customers to unlock data, accelerate industrial project modernization and digital maturity, increase productivity, and move the sustainability needle.

Our technologies help produce actionable insights that enable better decision-making and intelligence across the asset lifecycle of industrial projects, leading to improvements in safety, quality, efficiency, and productivity, which contribute to Economic and Environmental Sustainability.

Hexagon (Nasdaq Stockholm: HEXA B) has approximately 23,000 employees in 50 countries and net sales of approximately 4.6bn USD. Learn more at [hexagon.com](https://www.hexagon.com) and follow us @HexagonAB.